

SCART

EX DRIVE

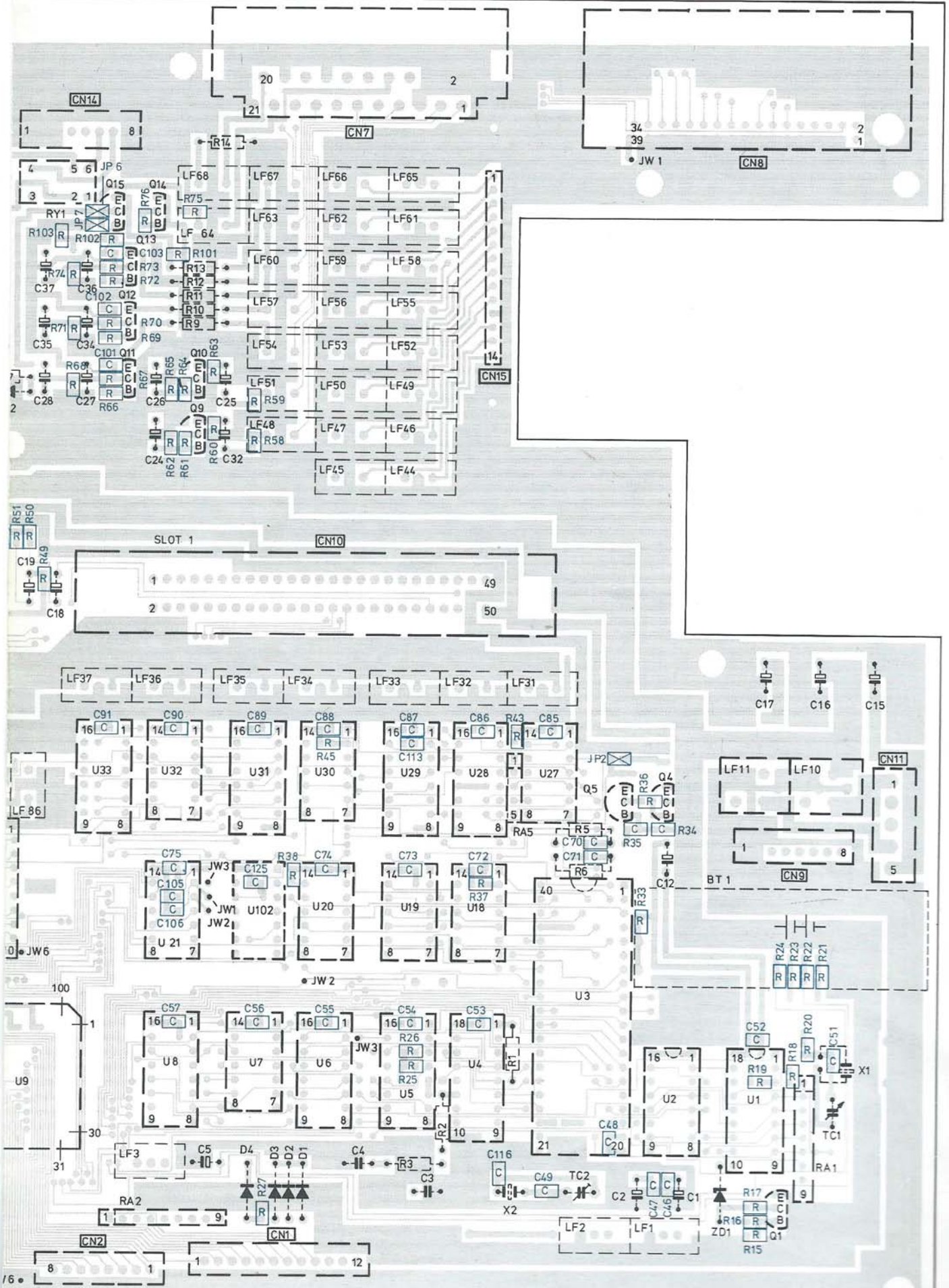

MAIN PRINTED BOARD FOR: VG8235 /00 from serial no. FF026 1101 0001 onwards
 /02 from serial no. FF016 1201 0001 onwards
 /19 from serial no. FF016 1201 0001 onwards

SLOT 2

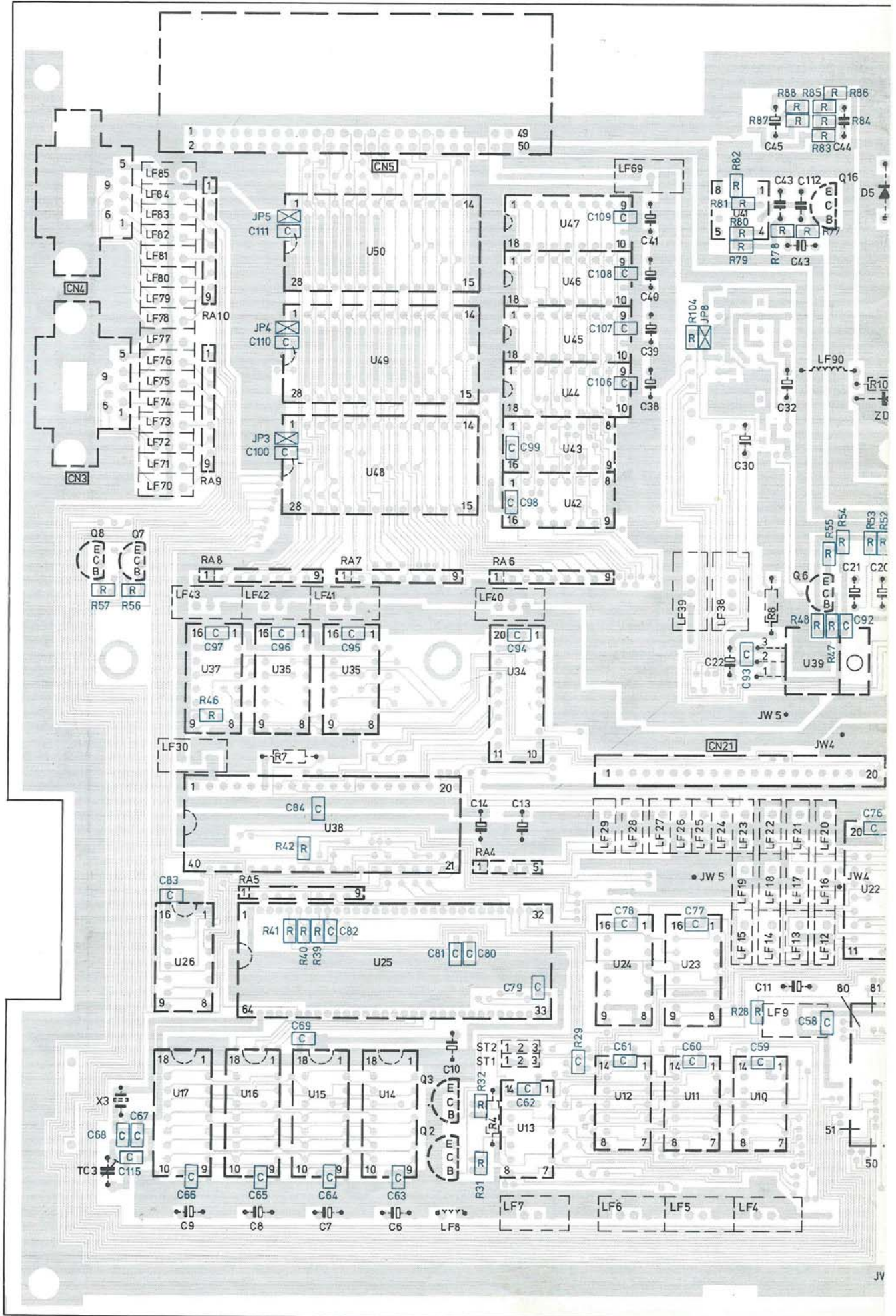

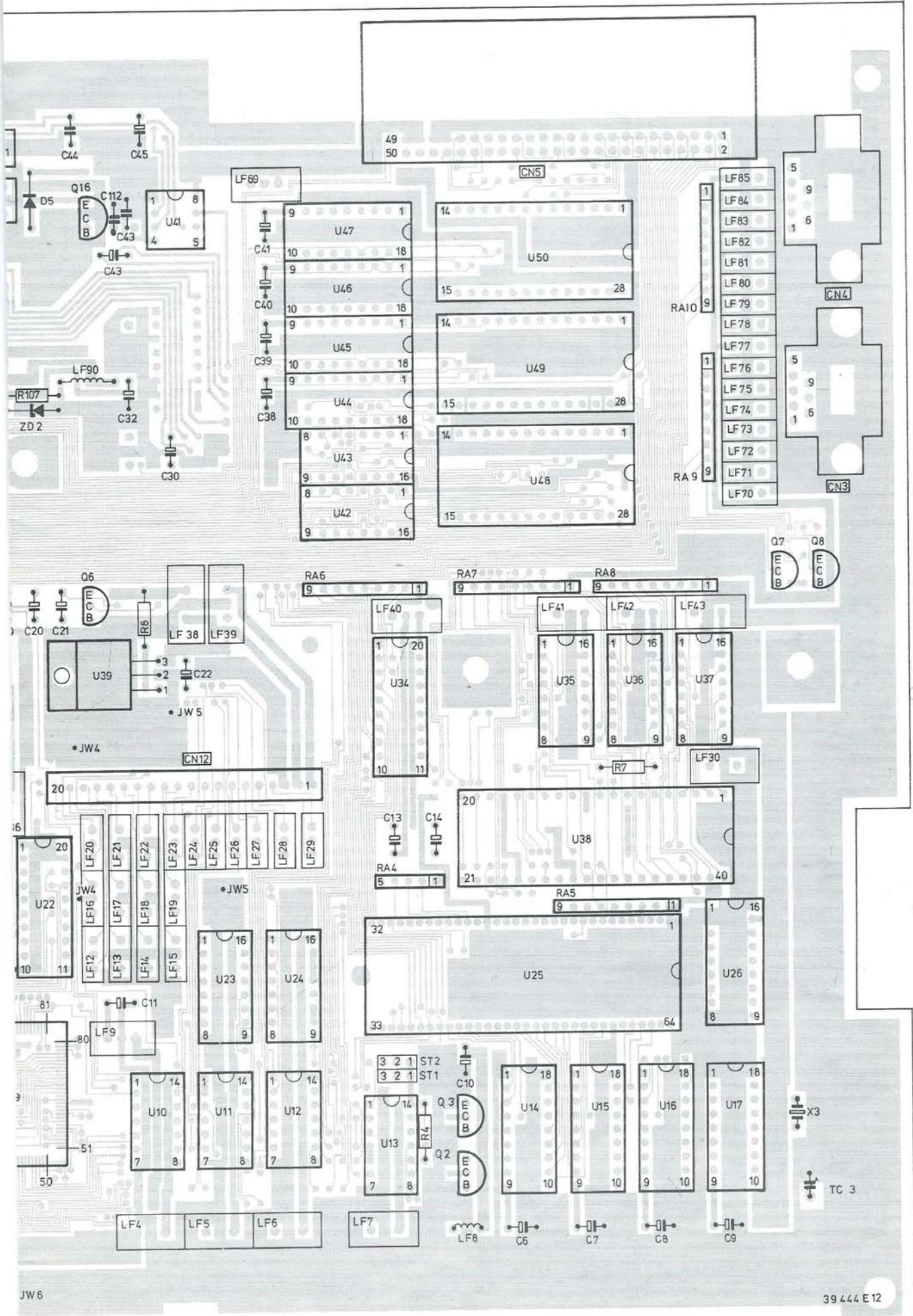

MAIN PRINTED BOARD FOR: VG8235 /00 from serial no. FF026 1101 0001 onwards
 /02 from serial no. FF016 1201 0001 onwards
 /19 from serial no. FF016 1201 0001 onwards

EX DRIVE

SCART

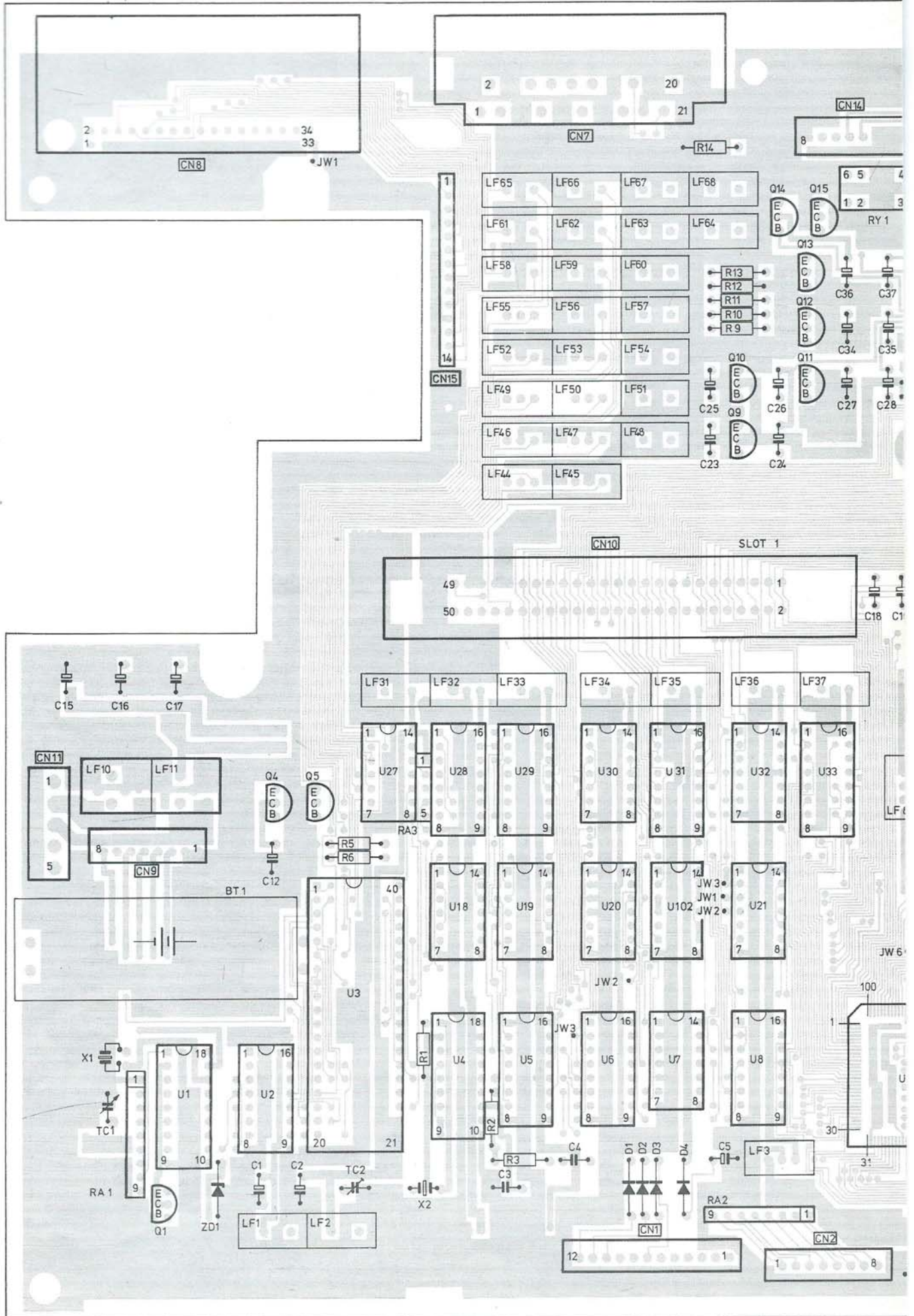

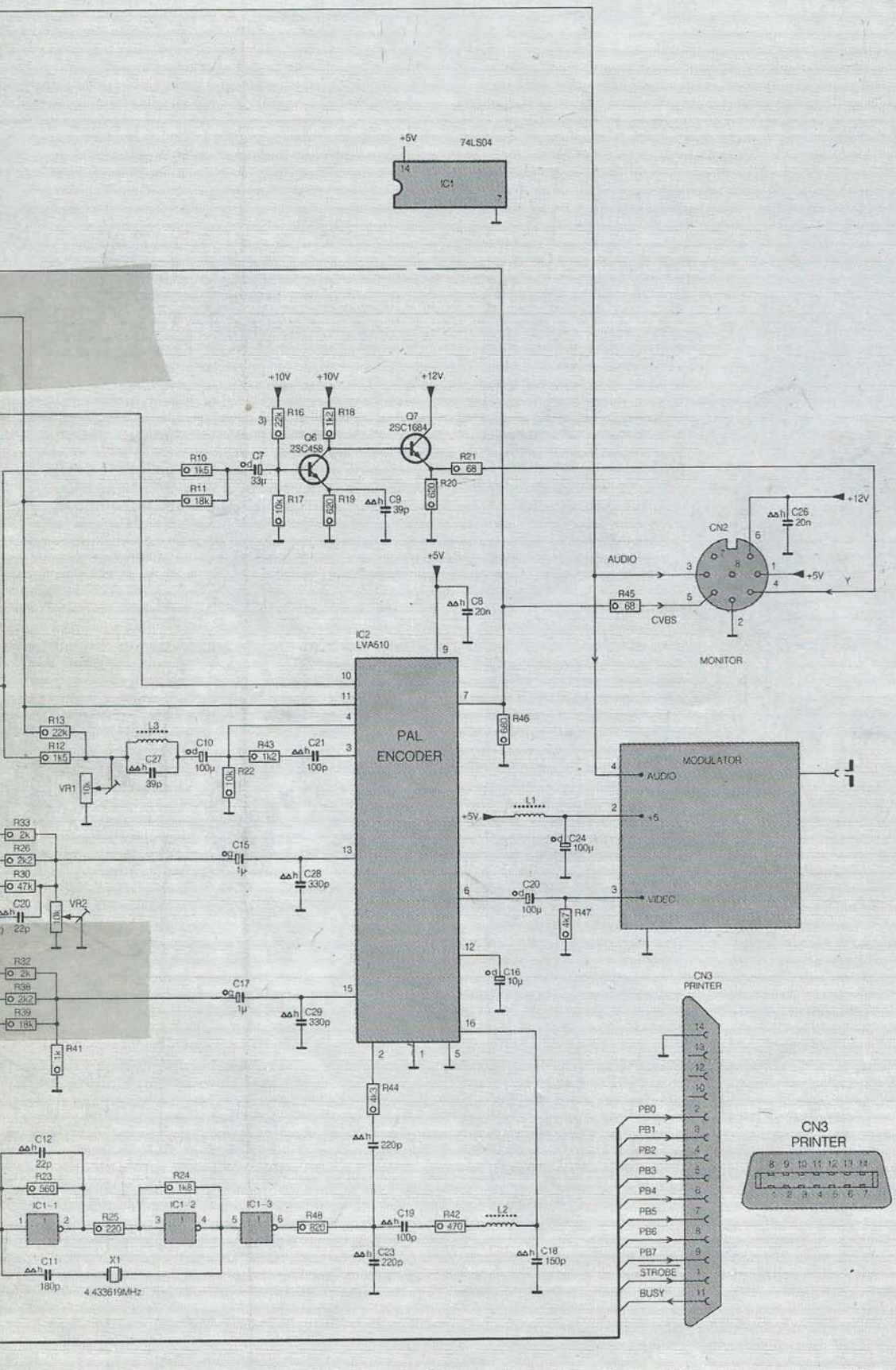

1)DELETED IN:
 2)ADDED IN:
 3)CHANGED TO 18k IN:
 VGR235
 /00 FROM SERIAL NO. FFO26 1101 0001
 /02 FROM SERIAL NO. FF016 1201 0001
 /19 FROM SERIAL NO. FF016 1201 0001

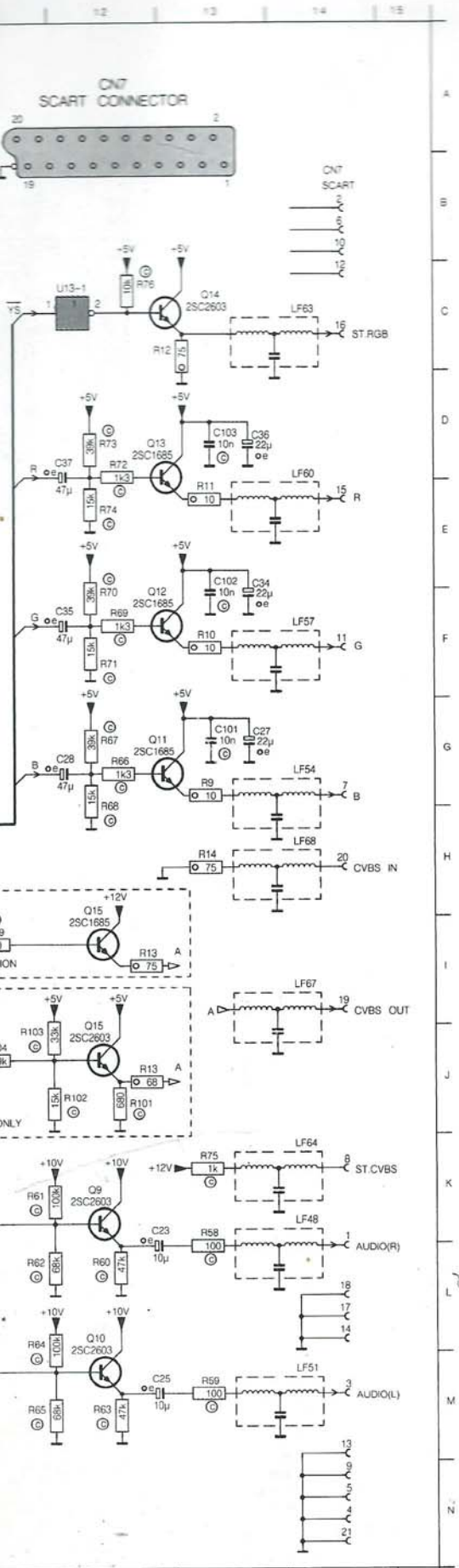

Component list table:

LF16	H 3
LF48	K14
LF51	M14
LF54	G14
LF57	F14
LF60	D14
LF63	C14
LF64	K14
LF67	I14
LF68	H14
LF8	B 6
O10	L12
O11	G12
O12	F12
O13	D12
O14	C13
O15	H12
O2	C 6
O9	F 5
O10	K12
R10	F13
R101	J12
R102	J12
R103	J11
R104	L11
R11	E13
R12	C13
R13	I12
R13	J12
R14	H13
R31	H 5
R32	F 5
R39	H 5
R4	H 4
R40	G 5
R41	F 5
R58	K13
R59	M13
R60	L12
R61	K11
R62	L11
R63	M12
R64	L11
R65	M11
R66	G12
R67	G12
R69	G12
R70	F12
R71	F12
R72	D12
R73	D12
R74	E12
R75	K13
R76	C12
R9	G13
RA5	B 5
TC3	L 6
U11-1	H 4
U13-2	F 4
U13-3	F 4
U13-4	G 4
U14	C11
U15	C 9
U16	C10
U17	C 8
U25	C 7
X3	L 6

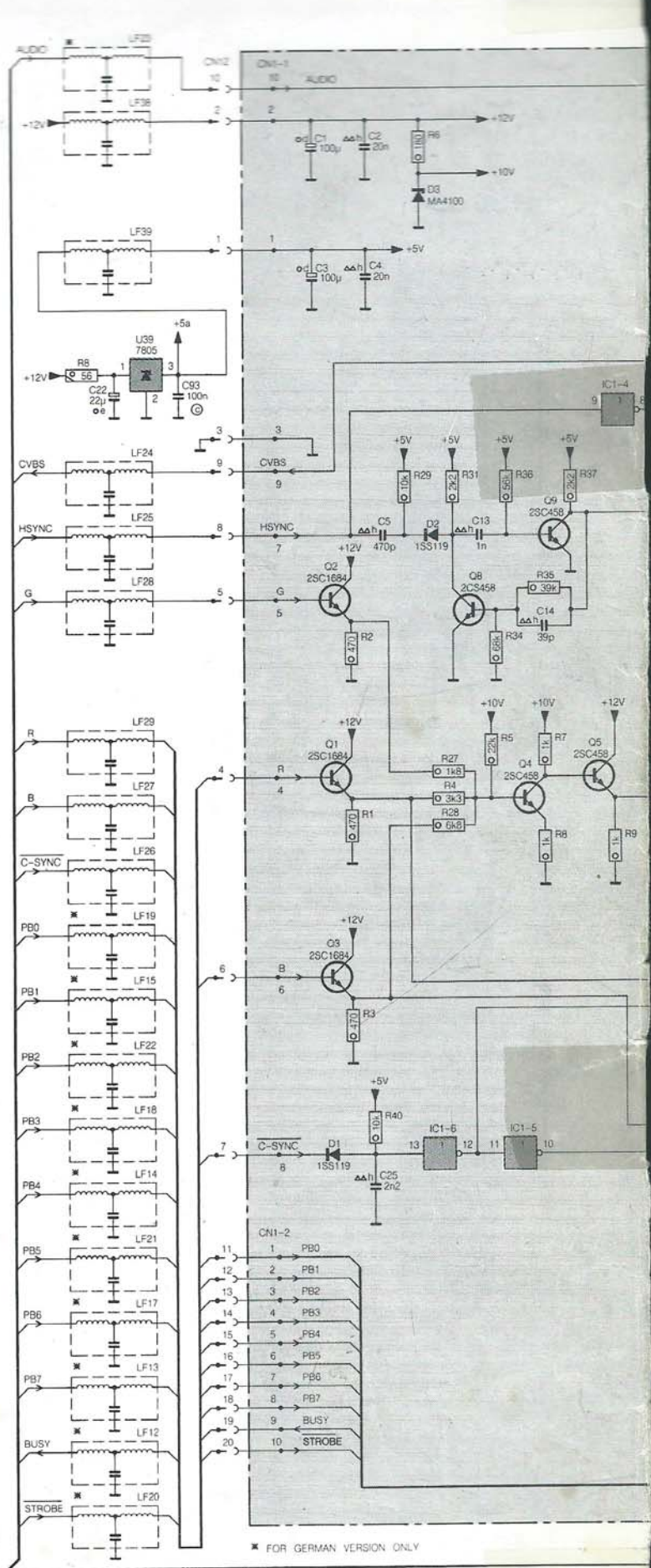

Handwritten notes at the bottom of the page:

- OTHER R102 R103 R104
- Cabler Base ~~Q2~~
- non
- Base Q15

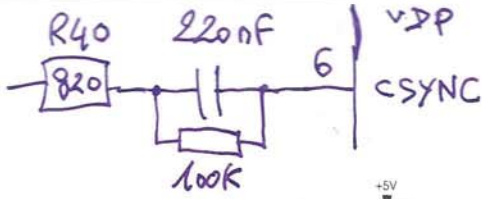

modif 7MHz other R39
 modif 2+

6VDP
 ← CSYNC
 Q15
 1K
 R20

